

For construction, maintenance, clearing and demolition risk refer to the relevant method statements and risk assessments related to this task for scheme Ref. C2016_BC00129_02.
In addition to the hazard/risk normally associated with the types of work detailed on this drawing take note of the following. All works on this drawing will be carried out by a competent contractor working to an appropriate method statement and risk assessments.

NOTES:

1. All dimensions in metres except where stated otherwise

LEGEND:

- EXISTING ROAD MARKINGS TO REMAIN
- EXISTING ROAD MARKINGS TO BE REMOVED
- PROPOSED ROAD MARKINGS
- PROPOSED YELLOW ROAD MARKINGS

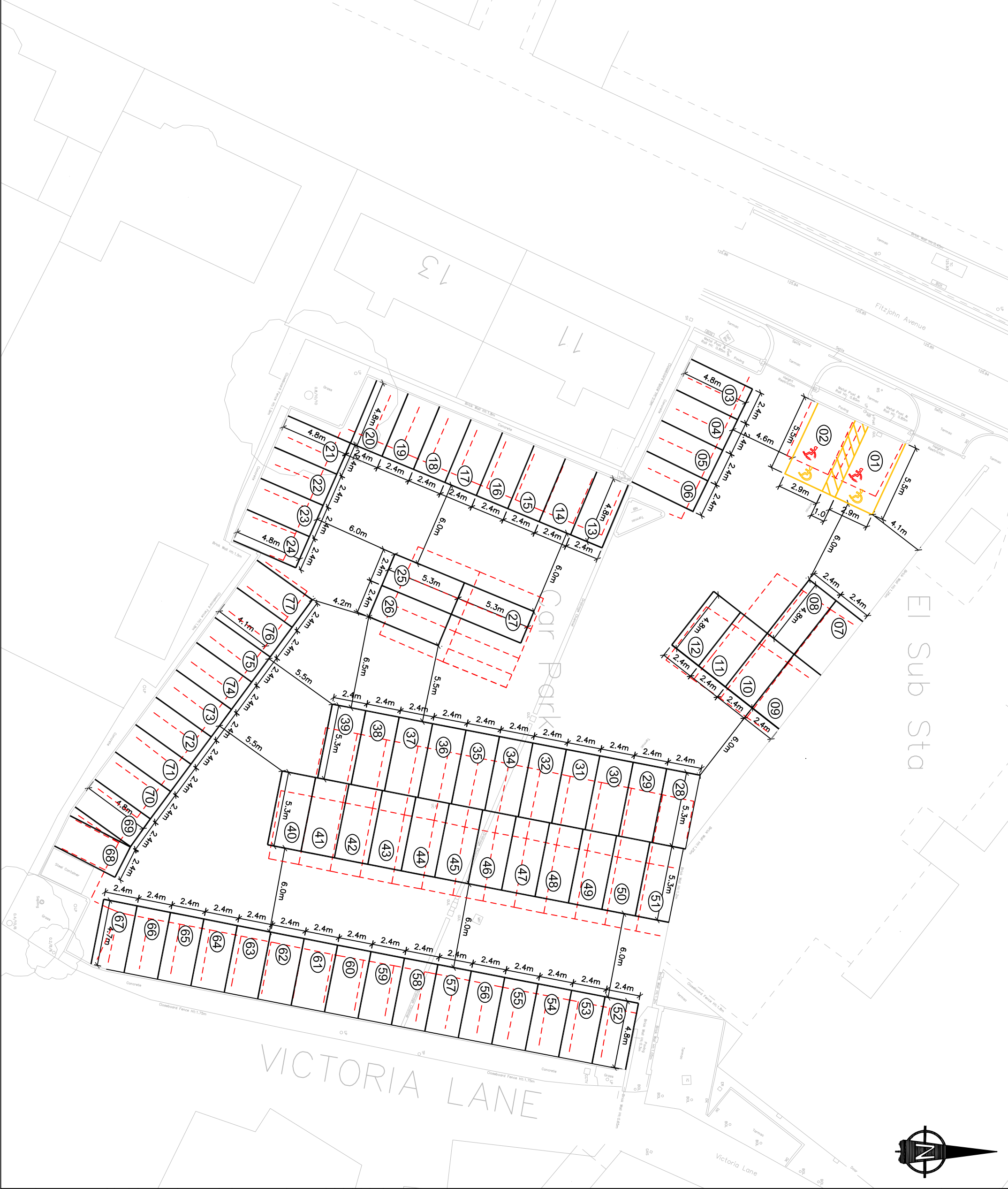

REVISION			
Revision Details	Design/Check	Date	Rev.
Initial Issue			

Purpose of Issue

DRAFT

Client:



Re Scheme Ref. C2016_BC00129_02

Scheme title

FITZJOHN CAR PARK

Drawing title

PROPOSED LAYOUT OPTION 1

Scale @ A3:

Design	MF	Drawn	MF	Checked	xx	Approved	xx
Date:	16/02/17	Date:	xx/xx/xx	Date:	xx/xx/xx	Date:	xx/xx/xx



Traffic and Development
London Borough of Barnet, Barnet House,
11th Floor, Highways, 1255 High Road,
Winstone, London W20 0EU